

**INSTALLATION INSTRUCTIONS
VERTEX SIDE STEPS PART # 6941266**

FORD F-150 SUPER CREW

Do not attempt to install this product on any vehicle other than the one listed above!

PARTS LIST

ITEM	QTY.	PART #	DESCRIPTION	TORQUE
1	1		Side Step driver	-
1	1		Side Step Passenger	-
2	1		Hardware brackets kit	-
3	6	69412664AA	Bracket	-
4	2	371980EA	3/8" Bolt plate	30 Lb.ft
5	1	KTE-6941266G4	Hardware kit	-
6	6	-	3/8" Clip nut black plated	30 Lb.ft
7	6	-	3/8 x 1 1/4" Hex head bolt zinc plated	30 Lb.ft
8	6	-	3/8 x 1" Carriage head bolt zinc plated	30 Lb.ft
9	12	-	3/8" Flat washer zinc plated	-
10	12	-	3/8" Lock washer zinc plated	-
11	8	-	3/8" Hex nut zinc plated	30 Lb.ft
12	12		M8 x 25mm Hex head bolt zinc plated	
13	12		nut flange M8	
14	12		Shim for screw	
15	2	-	3/8" Gasket vinyl	-

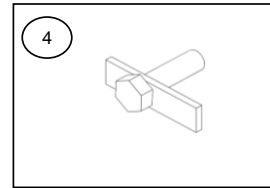
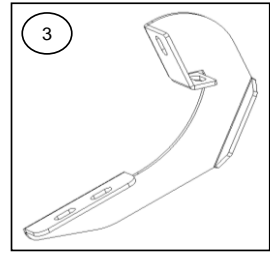

ASSEMBLY & INSTALLATION TOOLS REQUIRED:

1/2" Socket & 1/2" Wrench
9/16" Socket & 9/16" Wrench
Ratchet
Extension.

Approximate installation time: 40 min.

Read the assembly and installation instructions completely and verify that all of the parts listed are accounted for. If you have defective, missing or damaged parts or need assistance, please contact Go Rhino Products for fast, friendly customer service at: 1-888-427-4466 or email: warranty@gorhino.com

It is the customer's responsibility to protect the finish with a regular application of a nonabrasive polish compatible with the products finish. **NOTE: LOOK THE POSITION BEFORE INSTALLING THE BRACKETS.**

INSTALLATION

Step-1 Located holes inside the body of vehicle, front, middle, rear, **see picture 1 & 2**, place a 3/8" clip nut in upper part. Mount bracket and attach with: 3/8 x 1 1/4" hex head bolt, 3/8" flat and lock washers. In lower part attach with: 3/8 x 1" carriage head bolt, 3/8" flat and lock washers, 3/8" hex nut. **SEE ILLUSTRATION 1.** Leave loose. Repeat in opposite side.

PHOTO 1

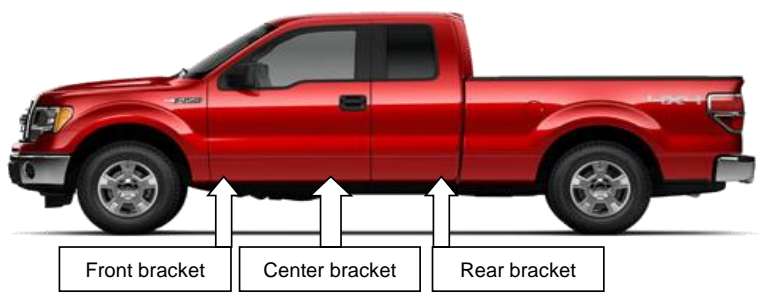
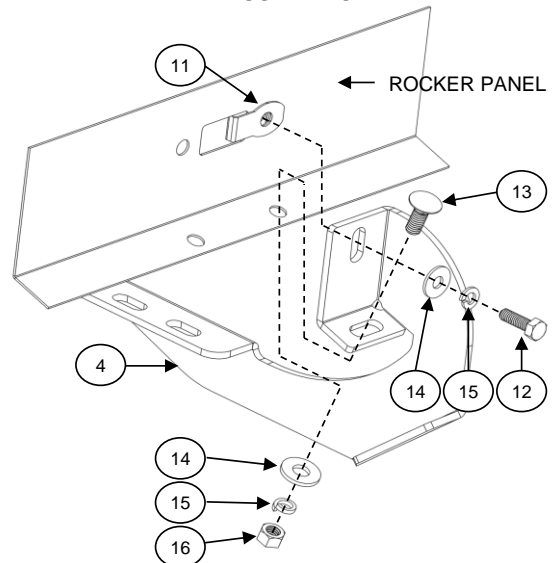
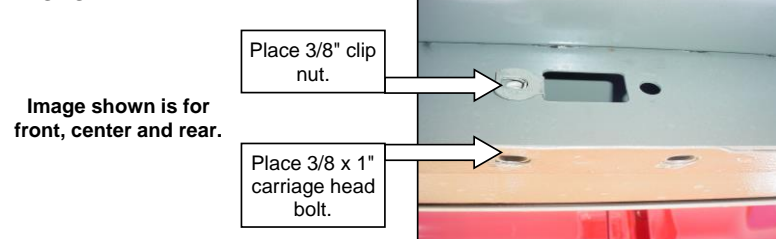

ILLUSTRATION 1



Use wrench, ratchet, hex socket 9/16".

PHOTO 2



NOTA: Models 2009 - 2010 insert 3/8" bolt plate, gasket vinyl, middle part, attach with: 1 3/8" flat and lock washers, 3/8" hex nut. In lower part attach with: 3/8 x 1" carriage head bolt, 3/8" flat and lock washers, 3/8" hex nut. **SEE PICTURE 3 & ILLUSTRATION 2.** Leave loose. Repeat in opposite side.

PHOTO 3



In models 09 - 10 middle part. Passenger side shown.

ILLUSTRATION 2

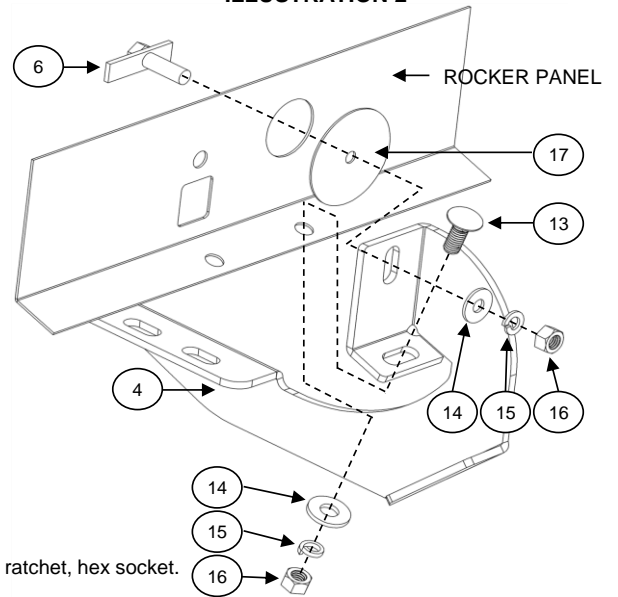

Step-2 Insert the bolt & shim assembly into the rails of the inner aluminum extrusion at the underside of the side step **Photo 4.** Each side step requires (6) M8 x 25mm. Hex bolt, 2 at the front, 2 at the rear, and 2 at the middle.

Step-3 Place the Side step on the brackets using (6) nut flange M8, . **Photo 5.**

Photo 4

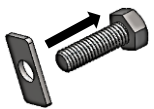

Insert the shim to the bolt.



Photo 5



Step-4 Align the side step with the vehicle and tighten all brackets and side steps nuts and bolts. Repeat the above steps to install the passenger side brackets and side step. Remember to check and retighten the nuts and bolts every six months.



Installed product