

ROUGH COUNTRY

SUSPENSION SYSTEMS®

FORD 2022 Maverick Hood Assist

Thank you for choosing Rough Country for all your vehicle needs.

Please read instructions before beginning installation. Check the kit hardware against the kit contents shown below. Be sure you have all needed parts and know where they go.

If question exist, please call us @1-800-222-7023. We will be happy to answer any questions concerning this product.

Check all fasteners for proper torque. Check to ensure for adequate clearance between all components.

Periodically check all hardware for tightness.

Kit Contents:

Dr Hood Bracket x1
 Pass Hood Bracket x1
 Dr Body Bracket x1
 Pass Body Bracket x1
 Wash Bottle Relocation Bracket x1
 Hood Assist Cylinders x2

Tools Needed:

10mm Socket/Wrench
 12mm Socket/Wrench
 13mm Socket/Wrench

Hardware Included:

6mm x 16mm Bolt x1
 6mm Lock Nut x1
 6mm Flat Washer x1
 5/16" x 1" Ball Studs x4
 5/16" Flange Nuts x4



Torque Specs:

Size	Grade 5	Grade 8	Size	Class 8.8	Class 10.9
5/16"	15 ft/lbs	20ft/lbs	6MM	5ft/lbs	9ft/lbs
3/8"	30 ft/lbs	35ft/lbs	8MM	18ft/lbs	23ft/lbs
7/16"	45 ft/lbs	60ft/lbs	10MM	32ft/lbs	45ft/lbs
1/2"	65 ft/lbs	90ft/lbs	12MM	55ft/lbs	75ft/lbs
9/16"	95 ft/lbs	130ft/lbs	14MM	85ft/lbs	120ft/lbs
5/8"	135ft/lbs	175ft/lbs	16MM	130ft/lbs	165ft/lbs
3/4"	185ft/lbs	280ft/lbs	18MM	170ft/lbs	240ft/lbs



INSTALLATION INSTRUCTIONS

1. Lift the hood and remove the bolts on the sides of the engine bay behind the lights using a 10mm socket/wrench. **See Photo 1.**
2. Install the ball studs and flange nuts to the Dr/Pass body brackets using two 12mm wrenches. **See Photo 2.**

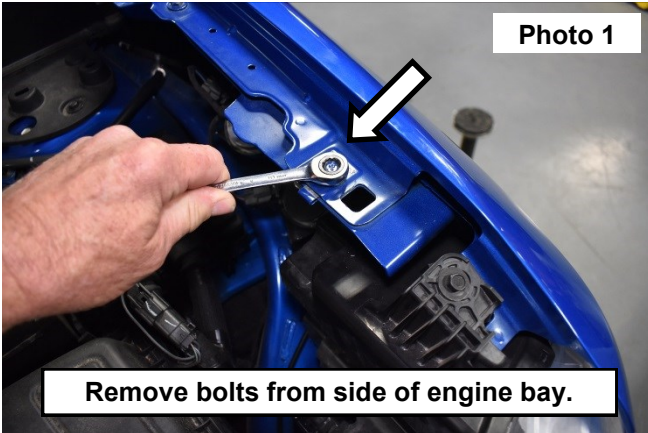

3. Install the Dr/Pass body brackets to the sides using the stock hardware. **See Photo 3.**
4. Install the ball studs and flange nuts to the Dr/Pass hood brackets using two 12mm wrenches. **NOTE: If combining this kit with the ditch lights, you will install the ditch light brackets to the hood bracket. See Photo 4.**

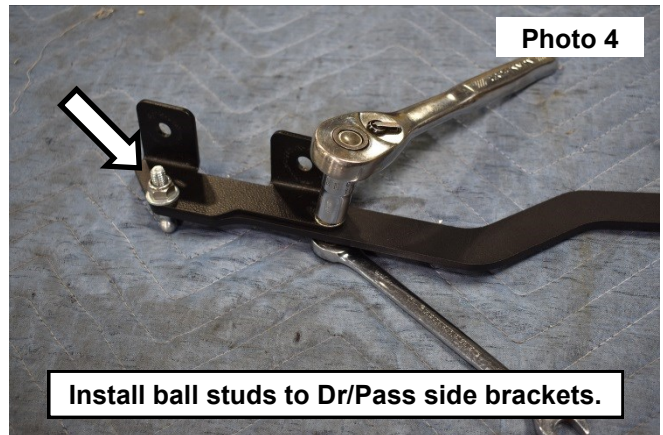

5. Have someone assist you with holding the hood up while you remove the nuts at the hinge joint using a 13mm socket/wrench. **See Photo 5.**
6. Install the Dr/Pass hood brackets to the hinge using the stock hardware. **See Photo 6.**

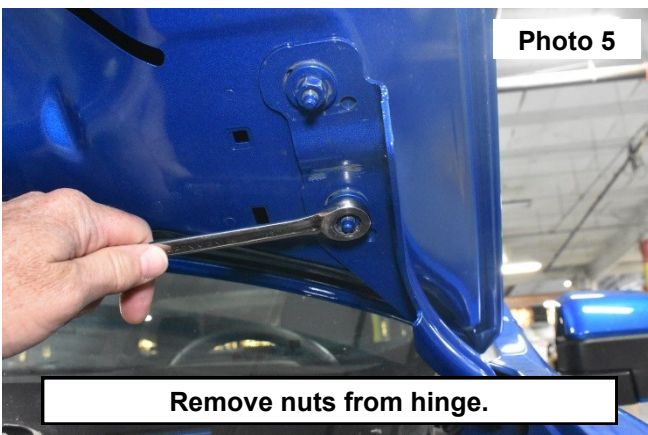

7. Install the cylinders to the ball studs. See **Photo 7** and **Photo 8**.

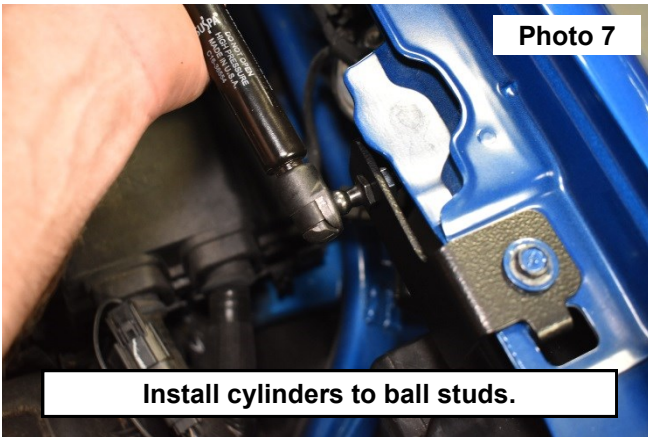

8. Remove the bolt securing the wash bottle using a 10mm socket/wrench. See **Photo 9**.
9. Install the relocation bracket with the supplied 6mm hardware using a 10mm socket/wrench. See **Photo 10**.

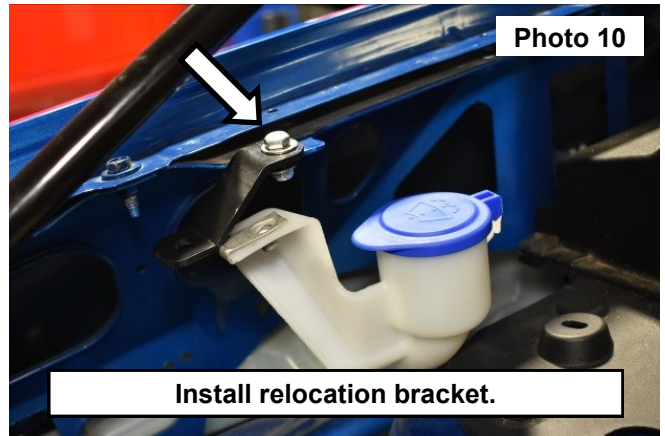

10. Secure the wash bottle to the relocation bracket using the stock bolt. See **Photo 11**.

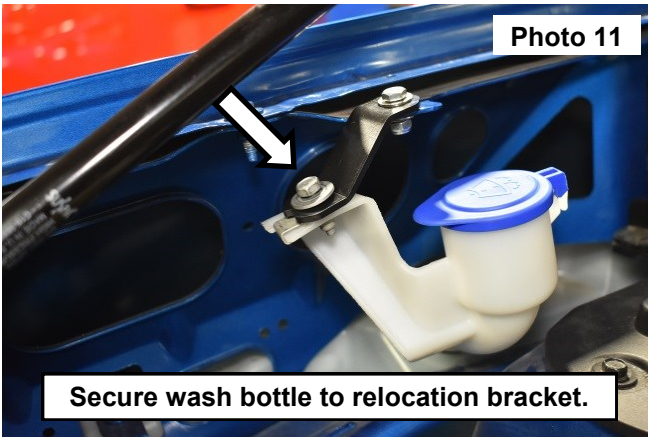

By purchasing any item sold by Rough Country, LLC, the buyer expressly warrants that he/she is in compliance with all applicable, State, and Local laws and regulations regarding the purchase, ownership, and use of the item. It shall be the buyers responsibility to comply with all Federal, State and Local laws governing the sales of any items listed, illustrated or sold. The buyer expressly agrees to indemnify and hold harmless Rough Country, LLC for all claims resulting directly or indirectly from the purchase, ownership, or use of the items.

