

CRAWLTEK R E V O L U T I O N

491 W. GARFIELD AVE., COLDWATER, MI 49036 • 517.278.1039
CRAWLTEKREVOLUTION.COM • E-MAIL: SALES-CRAWLTEK@RIDEFOX.COM

INSTALLATION INSTRUCTIONS

PYRO FRONT BUMPER

JL10101 - STUBBY
JL10201 - MIDWIDTH
JL10301 - FULLWIDTH

FOR USE WITH ALL
JL AND JLU MODELS FROM 2018+

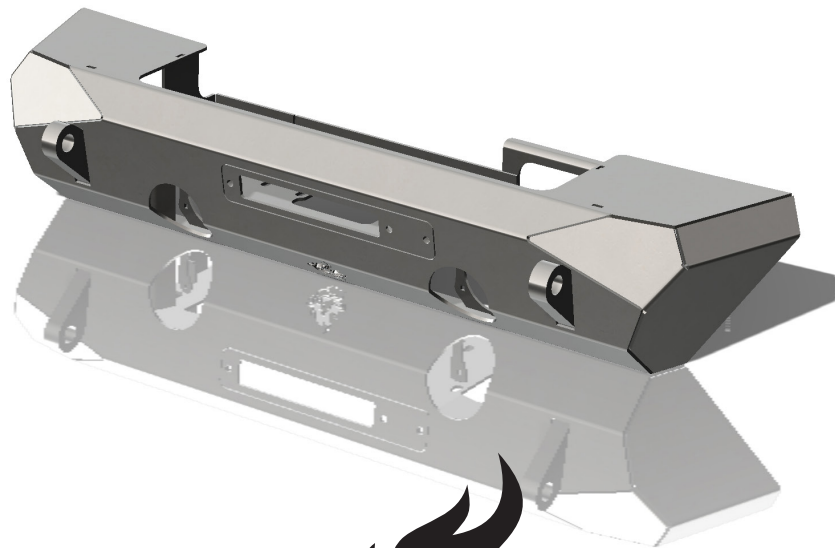

CrawlTek YouTube

PLEASE READ THROUGH INSTRUCTIONS BEFORE INSTALLING

2020-11-24

WHAT'S IN THE BOX?

PLEASE VERIFY KIT CONTENTS BEFORE BEGINNING INSTALLATION

PART #	Qty	DESCRIPTION
06032/06033/06034	1	BUMPER - JL FRONT - PYRO
06025	2	ADAPTER PLATES
06030	1	JK PYRO FRONT BUMPER NUTSTRIP - YELLOW ZINC
06031	1	JK PYRO FRONT BUMPER FAIRLEAD MOUNT
CWLU30010	1	DECAL: CRAWLTEK GEARSHIFT 3.5" X 3.5"
CWLU30020	1	DECAL: CRAWLTEK EYES 6" X 2"
CWLU30030	1	DECAL: CRAWLTEK JAX 3.75" X 2.8"
	8	7/16"-14 X 1-1/2" GRADE 8 YELLOW ZINC HEX CAP SCREW
	8	7/16"-14 ZINC FINISH SERRATED FLANGE NUT
	8	7/16" PUSHNUT BOLT RETAINER 27/32" O.D. ZINC
	8	7/16"-14 X 1" GRADE 8 YELLOW ZINC HEX CAP SCREW
	8	7/16" X 0.922" YELLOW ZINC STEEL SAE FLAT WASHER
	1	3/8"-16 X 1-1/4" GRADE 5 ZINC FINISH HEX CAP
	2	3/8"-16 X 3/4" STAINLESS STEEL BUTTON SOCKET CAP SCREW
	1	3/8" X 0.812" YELLOW ZINC STEEL SAE FLAT WASHER
	2	3/8"-16 ZINC SERRATED FLANGE NUT
	1	M6-1.0 X 50MM CLASS 10.9 YELLOW ZINC FINISH HEX CAP SCREW
	1	M6 X 12MM OD YELLOW ZINC GENERAL PURPOSE FLAT WASHER
	1	M6-1.0 FREE SPINNING WASHER NUT 19MM OD YELLOW ZINC
	8	AUVECO #14002 - NYLON NUT #6 SCREW SIZE .060-.150 RANGE

TOOLS REQUIRED

SAFETY GLASSES

18MM SOCKET OR WRENCH

10MM SOCKET OR WRENCH

11/16" SOCKET OR WRENCH

5/8" SOCKET OR WRENCH

9/16" WRENCH

7/16" SOCKET

3/16" ALLEN HEAD SOCKET



FLAT HEAD SCREWDRIVER

SMALL HAMMER

PRE-INSTALLATION NOTES

1. IF INSTALLING A LARGE BODIED WINCH ADDITIONAL CUTTING MAY BE REQUIRED TO THE TOP OF THE FRAME HORNS.
2. THE FACTORY OFFERS 3 DIFFERENT FACTORY FOG LIGHTS. THE PYRO BUMPER IS COMPATIBLE WITH THE 4 BOLT MOUNTING HALOGEN FOG LIGHTS ONLY. IS NOT COMPATIBLE WITH FACTORY 4 BOLT MOUNTING LED FOG LIGHT OR 3 BOLT MOUNTING FOG LIGHT.

FACTORY FRONT BUMPER REMOVAL

STEP 1:

REMOVE 2 CLIPS HOLDING TRIM PIECE ON.

STEP 2:

DISCONNECT FOGLIGHT PLUG RUNNING DRIVER FRAME RAIL.

STEP 3:

REMOVE FACTORY (8) BUMPER BOLTS, AND REMOVE FROM VEHICLE.

STEP 4:

UNBOLT BRACKETS FROM BOTH SIDES OF FRAME RAILS, THESE WILL NOT BE USED WITH THE NEW BUMPER

STEP 5:

DISCONNECT FACTORY FOG LIGHTS.

STEP 6:

REMOVE FACTORY FOG LIGHTS AND HARNESS FROM FACTORY BUMPER, KEEP (8) FACTORY SCREWS.

ASSEMBLING THE PYRO FRONT BUMPER

STEP 7:

INSTALL (8) NYLON NUTS INTO BUMPER FOGLIGHT MOUNTING BRACKETS.



FIG.5

STEP 7:

INSTALL FACTORY FOG LIGHTS REUSING (8) FACTORY SCREWS.

INSTALLATION OF THE PYRO FRONT BUMPER

STEP 8:

RECONNECT FOGLIGHT HARNESSSES AND SET BUMPER ONTO FRAME RAILS. USING A SLIGHT UPWARD ANGLE TILT THE BACK OF THE BUMPER BACK AND OVER THE FRAME HORNS. IF YOU ARE INSTALLING A WINCH YOU MAY NEED A HELPER, AS THE WINCH AND BUMPER ASSEMBLY ARE HEAVY.

STEP 9:

ATTACH VACUUM PUMP TO BUMPER ASSEMBLY WITH SUPPLIED M6 HARDWARE.

STEP 10:

LIFT ONE SIDE OF THE BUMPER AT A TIME INTO POSITION AND INSTALL A 7/16" BOLT AND WASHER FROM THE REAR OF THE BUMPER THROUGH THE FRAME HORNS AND INTO THE BUMPER. ATTACH 7/16" SERRATED FLANGE NUT TO BOLT AND TIGHTEN.

STEP 11:

INSTALL THE REVERSIBLE FAIRLEAD BRACKET WITH THE 3/8 BUTTON HEAD AND FLANGE NUT. IF YOU INSTALLED A WINCH, INSTALL YOUR FAIRLEAD USING THE SUPPLIED HARDWARE.





YOU'RE NOT DONE YET!

Thank you for your new CrawlTek Revolution purchase! Follow us on facebook for up to date coverage of new product releases. We love feedback, if you have any questions about the installation or parts were missing please contact us at sales-crawltek@ridefox.com or call us at 517.278.1039.

*Be sure to show off your jeep to the rest of the CrawlTek Revolution online.
Find us on facebook and instagram to keep up on new products, upcoming events and more action.
Tag us @crawltek for a chance to get featured*

