



n-fab.com

a TRUCK HERO company

mfabinc f t

I-SHEET #: INST-00033

PART NUMBER: PRJ1846

PRODUCT: ALUMINUM HOOP STEP

APPLICATION: 18- C JEEP JL 2 DOOR

# PREDATOR PRO



HARDWARE DESCRIPTION	QTY.
# HWKT-00029X	1
M8 FENDER WASHER	4
M8-1.25MM X 35MM HEX CAP SCREW	4
1/4"-20 x 3/4 HEX CAP SCREW	8
1/4" USS FLAT WASHER	8
1/4"- 20 CLIP-ON NUT	4

**Step 1:** Identify Driver and Passenger side Nerf-step.

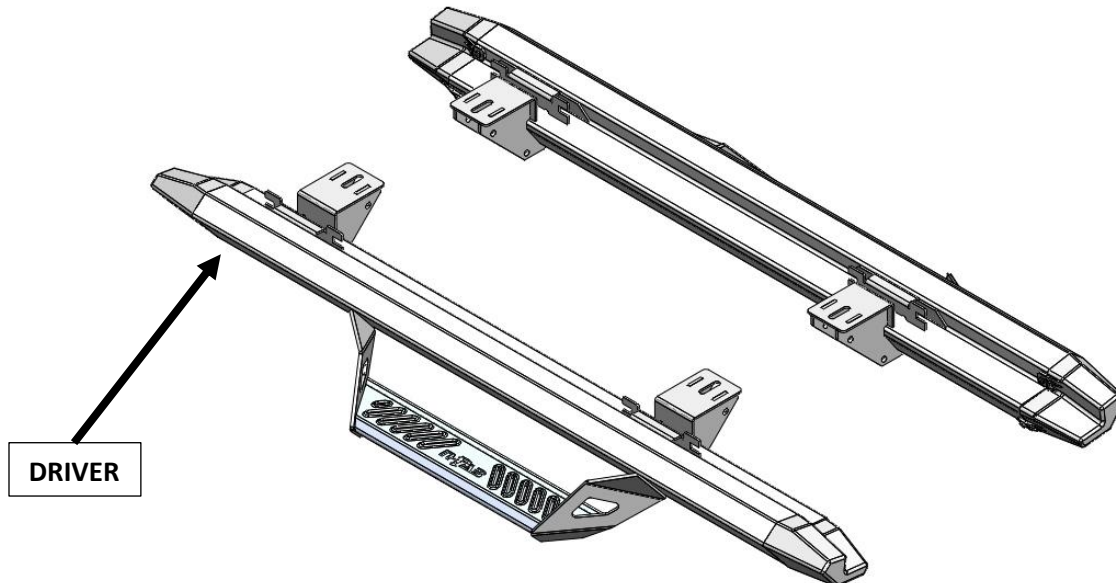

**Step. 2** Starting with the passenger side step rail, install the supplied (x4) 5/16" snap nuts into the two notches in each mounting bracket.

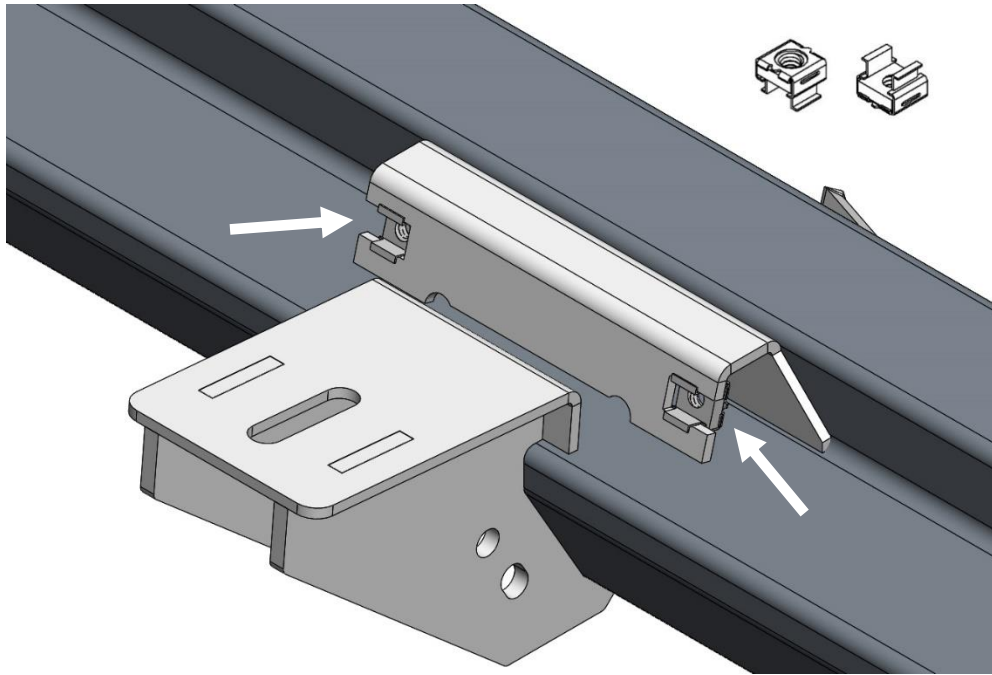

**Step. 3** Carefully raise step rail up to the pinch weld of the body and align brackets up with the factory mounting locations.

**Step. 4** Beginning with the front bracket start one of the supplied M8X30mm Hex bolts and leave loose to help steady the step to install the remaining hardware.



**Step 5.** Next, install the remaining M8x30mm hex bolts in the upper mount on the rear bracket and leave loose at this time.

**Step. 6** Next, start all (x4) ¼"x3/4" hex bolts and (x4) M8 flat washers in the upper bracket mounts through the pinch weld and leave loose.

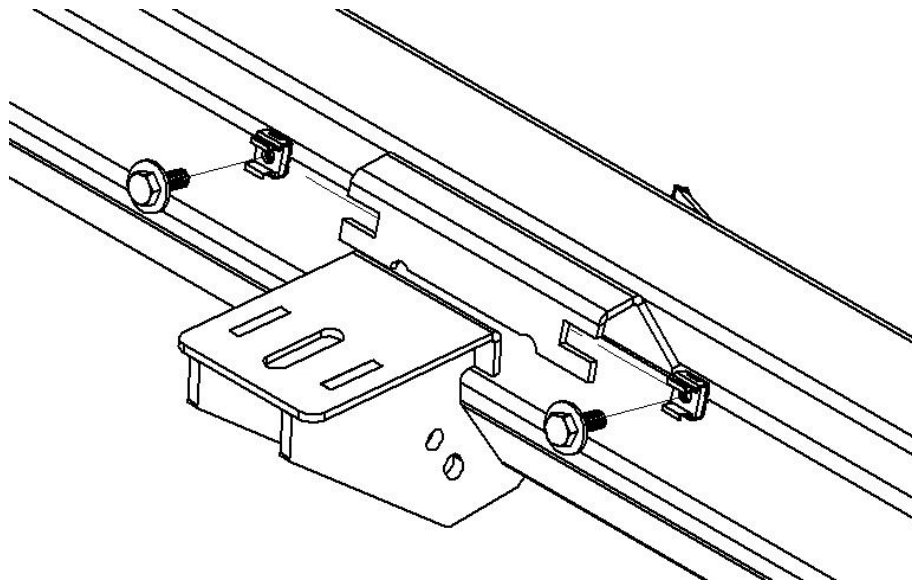

**Step. 7** After final positioning, tighten all (x4) ¼"x ¾" hex bolts no more than 6 ft/lbs. torque.

**Step. 8** Next, tighten all (x2) lower mounting positions to 17-20 Ft/lbs. torque.

**Step. 9** Repeat steps 2-8 for passenger side.